

# Assembly Instructions For

# OL7411 (E) 5/09

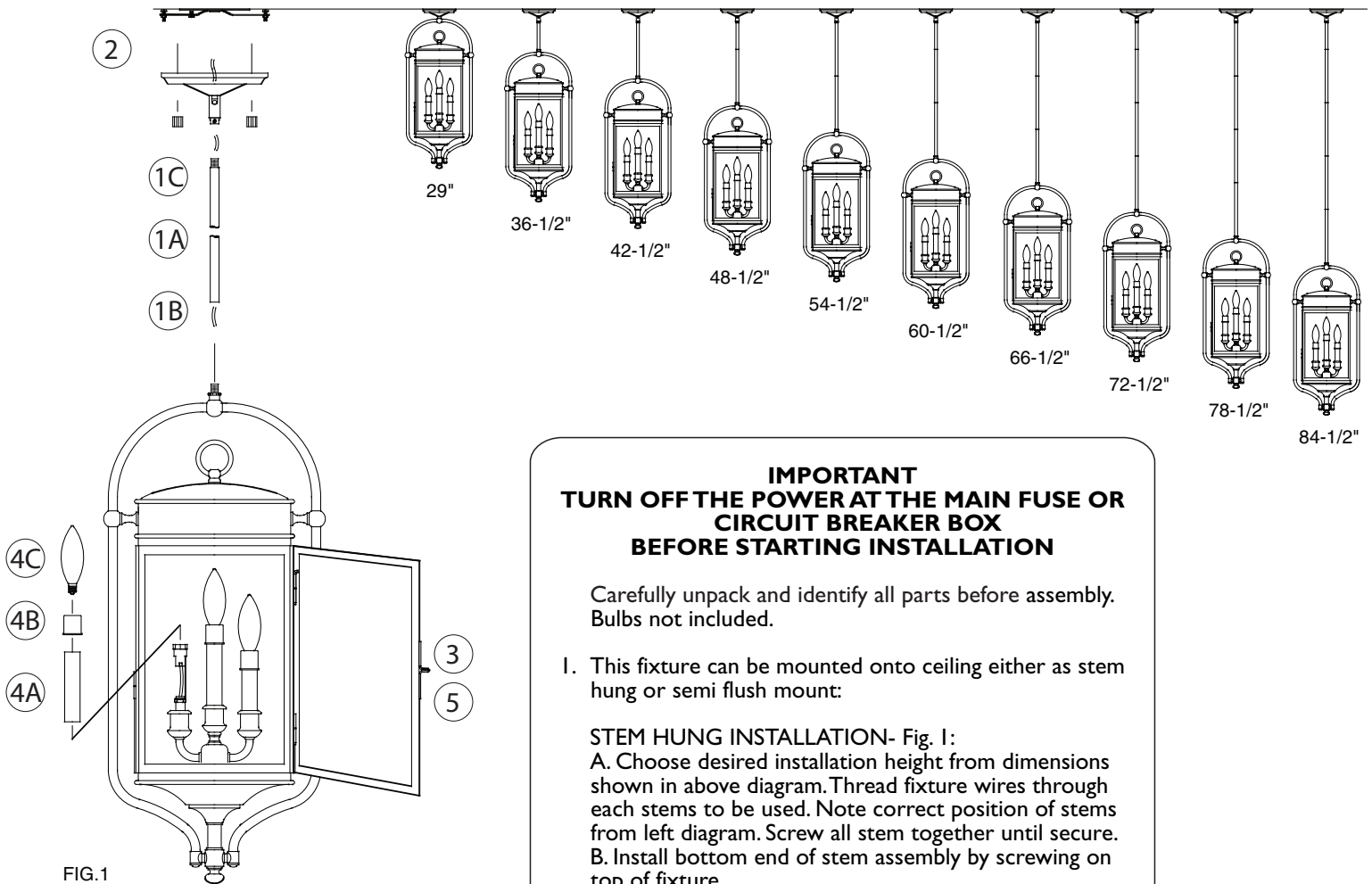

FIG.1

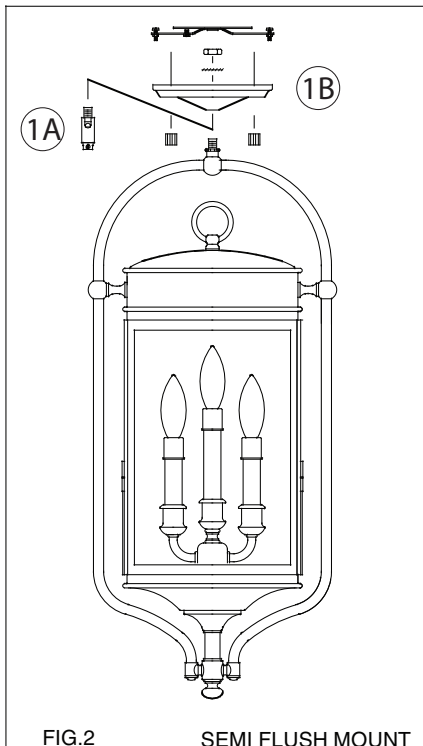

FIG.2

SEMI FLUSH MOUNT

## IMPORTANT TURN OFF THE POWER AT THE MAIN FUSE OR CIRCUIT BREAKER BOX BEFORE STARTING INSTALLATION

Carefully unpack and identify all parts before assembly.  
Bulbs not included.

1. This fixture can be mounted onto ceiling either as stem hung or semi flush mount:

### STEM HUNG INSTALLATION- Fig. 1:

A. Choose desired installation height from dimensions shown in above diagram. Thread fixture wires through each stems to be used. Note correct position of stems from left diagram. Screw all stem together until secure.

B. Install bottom end of stem assembly by screwing on top of fixture.

C. Pass fixture wire through swivel in canopy and screw top end of stem assembly onto swivel.

### SEMI FLUSH INSTALLATION-Fig. 2:

A. Remove and discard swivel.

B. Threaded fixture wires through canopy, lock washer, and hex nut. Lock all together on top of fixture by tightening hex nut.

2. Follow enclosed supplement installation instructions for electrical and fixture installation onto house outlet box. If you do not have an outlet box at desired location to attach the fixture than hire a qualified electrician to create one.
3. Lift latch to open door.
4. A. Slip candle tube over socket.  
B. Install candle follower over candle tube.  
C. Install type-B, candelabra base, of 60 Watt maximum bulbs (not included).
5. Close door.

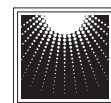

**MURRAY  
FEISS**  
Generation Brands™